

SURGICAL MICROSCOPE

STELLA OPH



A Shining New Beacon in Surgical Imaging



STELLA

A brilliant new era in surgical imaging technology is here. Stella promotes greater flexibility, performance, and affordability in vitreoretinal and cataract surgeries.

A multi-functional Stella delivers precision thanks to a 10-way foot control of optical and illumination features, and can easily adapt enhanced viewing systems in order to switch from anterior to posterior anatomy. A host of video accessories, intraoperative mode selections and controls make the Stella modular and responsive to your protocol.



PRECISE FUNCTIONALITY AT EVERY TURN



Stella provides ophthalmologists a waterproof foot control (10-way) that will effortlessly drive X, Y, and Z motors alongside mag change and light intensity adjustment functions. Conveniently housed in the arm system is an IR and UV safe LED (5700 kelvin) that will provide cool, crisp white illumination for more comfortable, accurate and safe practice.

Unlike other cylindrical columns, Stella's novel trapezoidal column system will pivot with the arm, distributing weight more evenly while maintaining a near perfect center of gravity for vibration free operation. With Stella's standard F=200mm objective lens, working distance is optimized for vitreoretinal surgery with fantastic depth of field. A F=175mm optional objective and wide field eyepieces with superior eye relief make the system ideal for vitreoretinal procedures.

An adjustable assistant viewer bridge provides for seamless co-observation of procedures, ensuring surgeon and assistant vision is in sync.

Select between daylight, blue barrier (yellow filter), fluorescein excitation (cobalt blue), vascular identification (green filter), anti-glare (two spot diaphragm) and retinal protection interoperative viewing modes. Co-axial red reflex can also be engaged with the flip of a switch, ensuring consistent and optimal image contrast for cataract surgery.



Magnification change is made convenient thanks to a responsive foot control, enabling surgeons to intuitively toggle between mag settings. Stella's EZTilt angle adjustable carrier articulates the microscope $\pm 180^\circ$ on axis, enabling angle changes in accordance with procedural requirements.



"My legacy microscopes always suffered from poor vibration dampening, forcing me to invest in costly mounting. Stella's pyramid stand concept allows us to maintain a floor stand that is totally balanced but also enables us situational flexibility."



CLEVER DESIGN ENHANCES MODULARITY AND SAFETY



A smooth, noise free motor drive will seamlessly transition the optical head in X, Y, and Z axes, enabling scanning of ocular anatomy with a high degree of sensitivity. Quickly reset XYZ center back to factory settings with the push of a button. A host of accessories are available from our ProLine series including beam splitters, DSLR camera adapters for all major makes and models, smart phone adapters, and an assistant viewer bridge for co-observation. With the addition to our Stella VESA mount, operators can add an HD monitor to the microscopes arm for live streaming and image preview.



For wide angle observation in vitreoretinal procedures, add a fundus viewing system to Stella's package. Stella's arm height can be limited with the rotation of a safety stop knob, keeping the arm from descending below a pre-set point, thus avoiding risk of injury to the patient.

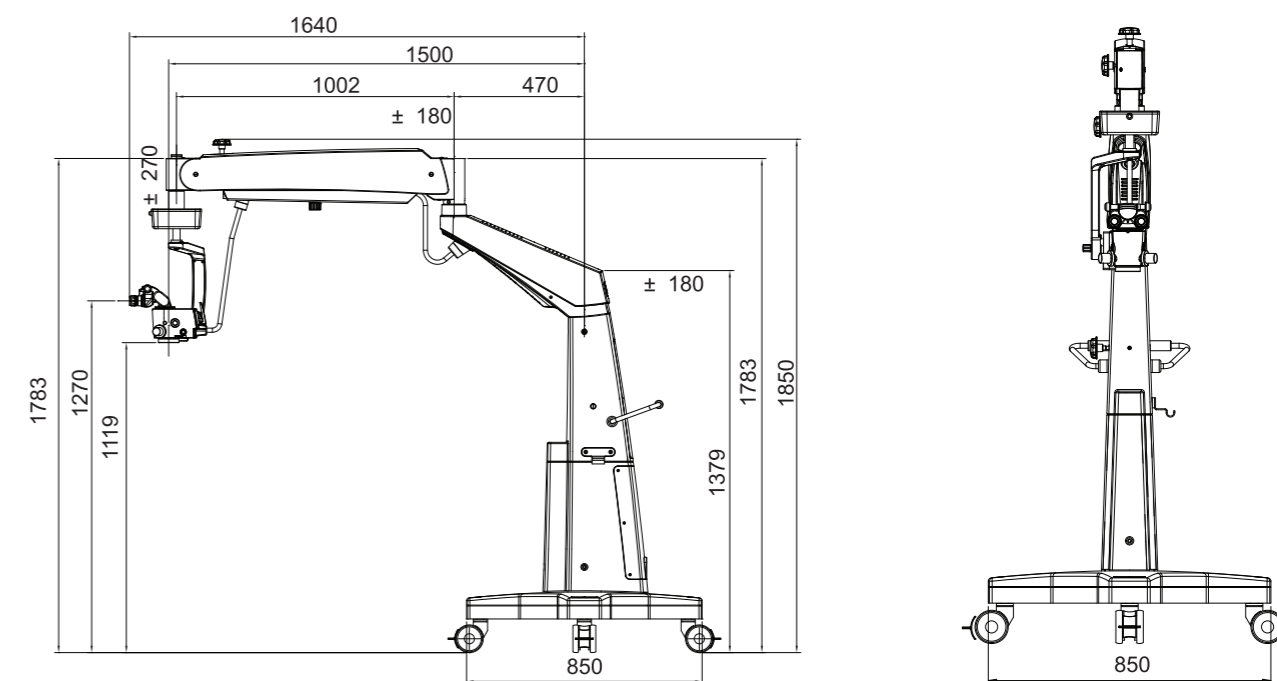

SYSTEM DIAGRAM

All dimensions in mm

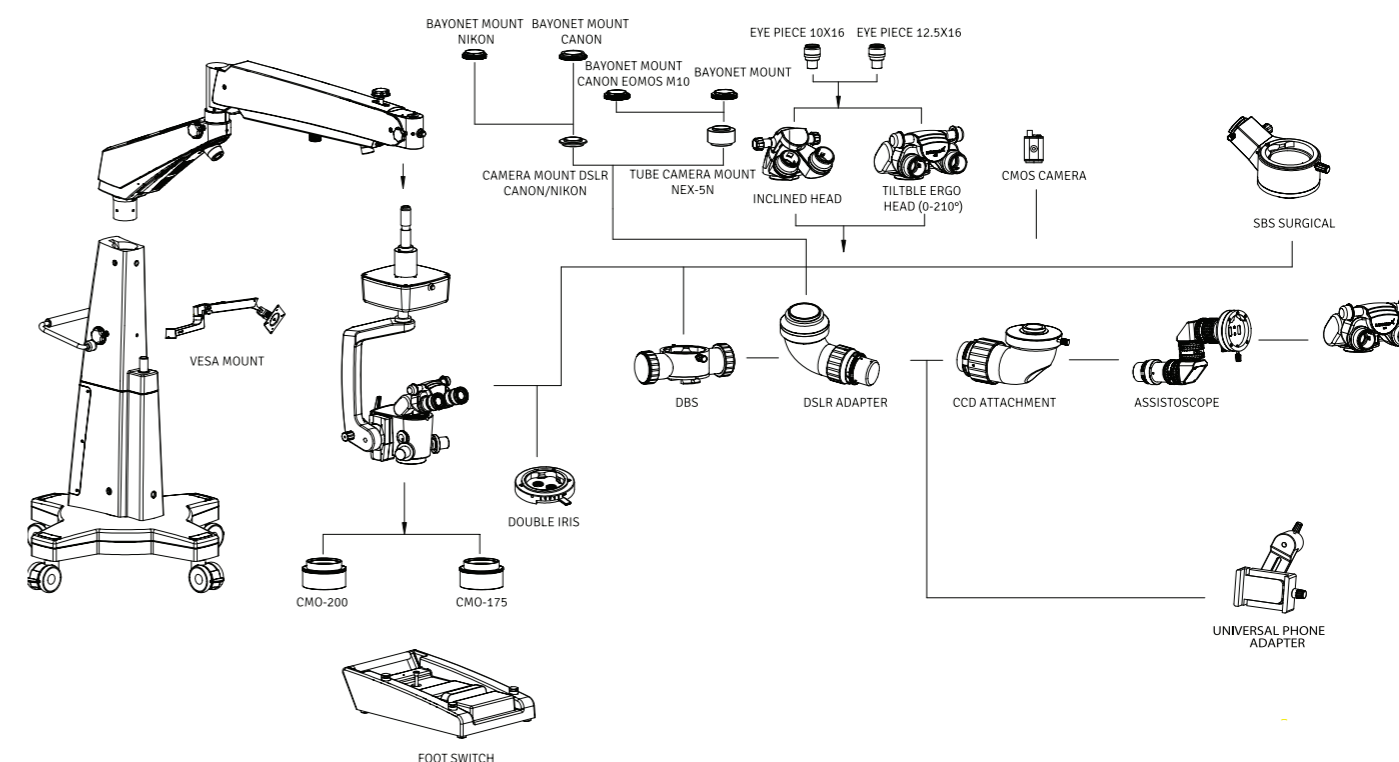

STELLA OPH

Stand	Robust, vibration free stand on cross base with four lockable castors
Observation tubes:	Standard: 0-210° Binocular tilt able head F=140mm configured with Double beam splitter & Double Iris attachment for depth of field management
Stereo Base:	24mm
Eyepieces:	Standard: WF 10X/18mm with eye guards Option: WF 12.5X/18mm with eye guards
Dioptr Adjustment:	12.5x ±8mm, 10x ±7mm
Magnichanger:	MaxLite coated, Apochromatic, motorized stepper zoom system (Tilttable and auto locked at any position) Motorized 5 steps: 0.4X, 0.6X, 1.0X, 1.6X, 2.5X
Objective:	Standard: f=200mm, Optional: f=175mm
FOV diameter:	64.30mm-10.30mm
Magnification Range:	2.80X-17.50X
Illumination field diameter:	55mm
Fine focus:	Range 40mm, motorized noise free
XY Travel:	50 X 50mm with auto reset
Light source:	UV & IR free 50W LED
LUX:	60K
Maximum Wattage:	200Watts
Colortemperature:	5700k
Built-in filters:	Flip in/out blue blocking (yellow), Green & Blue filter
Optional accessories:	Assistant binocular attachment, Proline range of camera adapters, Smart phone adapters and fundus viewing attachment
Swivel Arm:	470mm
Suspension Arm:	1000mm
Swivel Arm rotation:	±180°
Suspension Arm rotational:	±180°
X-Y rotation:	270°
Vertical movement of suspension arm:	±300mm
Foot Switch:	10 function wired foot switch for xyz, magchanger & intensity control
Max. Suspension load:	12kg
Base diameter:	850mm
Base & column weight:	170kg
Arm Weight:	24.5kg
X-Y, magchanger, head weight:	8.7kg
Total height:	1880mm
Maximum extension of arm:	1620mm

DESCRIPTION	CONFIGURATION	CATALOG NO.
STELLA	Floor Stand Retina	6219100
STELLA	Wall Mount Retina	6219101



Labo America, Inc.
920 Auburn Court
Fremont, CA 94538

Tel: (510) 445-1257

Fax: (510) 445-1317

E-mail: sales@laboamerica.com

www.laboamerica.com



DQS Inc.
Labo America Inc.
Registered to ISO 9001:2015
BR Number 10005565



A16372 ISO 13485 : 2016

LABOTECH MICROSCOPES INDIA Pvt Ltd

LABOMED

Distributor

With a policy of continuous development, Labo America, Inc. reserves the right to change design and specifications without prior notice.

SPECIFICATIONS

6219100-796/USA/E/ 1.0 300623
© Labo America, Inc. All rights reserved.